

Bluetooth & Analogue Audio Dante® Wall Plate EU

Description

The DA11ABL-WP-EU-V2 is a multi-input / output wall plate to convert Bluetooth and analogue audio within a digital Dante® networked audio system. The DA11ABL-WP-EU-V2 converts 2 input channels of Bluetooth or unbalanced audio to Dante® digital audio, and 2 channels of Dante® audio to 2 x output channels of unbalanced audio.

The DA11ABL-WP-EU-V2 is a plug & play device that is powered using PoE (Power over Ethernet), or via 12V power supply, offers support for AES67 RTP audio transport and magnetic faceplate design allows for both UK & EU backbox compatibility. The DA11ABLWP-EU-V2 is the ideal BYOD interface to allow any Bluetooth device to stream audio wirelessly to a Dante® audio system.

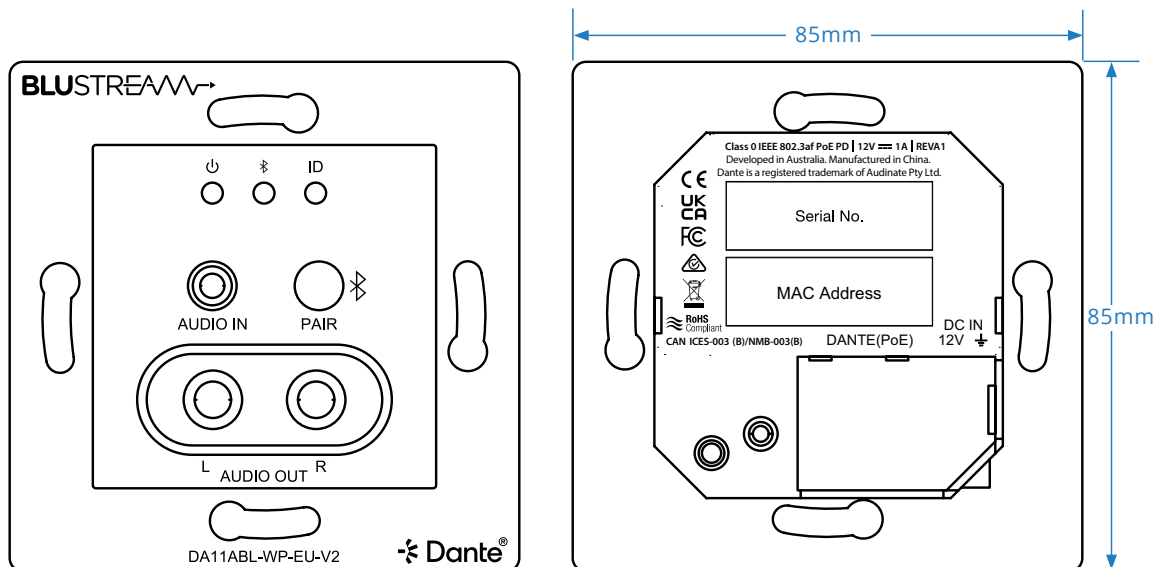

Key Features

- Dante® network wall plate interface for Bluetooth and analogue L/R audio inputs, and L/R audio outputs
- Converts 2ch Bluetooth, or un-balanced audio sources to Dante® audio
- Converts 2x Dante® audio channels to un-balanced audio outputs
- Adjustable input sensitivity from +24dBu to -28dBV (analogue input only), and output gain from +20dBu to -28 dBV via web GUI or API
- Dante® Audio Supports 44.1, 48, 88.2 & 96KHz sample rates @ 16, 24 & 32-bit
- Configurable Dante® device latency (supports 2, 3, 4, 5 or 10ms configurable using Dante® Controller)

- Supports AES67 RTP audio transport
- Features Class 0 IEEE 802.3af PoE for powering of product from any PoE switch
- Supports power via 12V DC adapter (not included) for when network switch does not support PoE
- White magnetic faceplate surround allowing for both UK & EU backbox compatibility
- In-built web-GUI for configuration and control

**Dante® is a registered trademark of Audinate Pty Ltd*

Blustream cannot be held responsible for errors in typography or photography. Specifications are subject to change without notice.



Specifications

- **Module Dimensions (W x H x D):** 74mm x 74mm x 50mm (without faceplate)
- **Faceplate Dimensions (W x H x D):** 85mm x 85mm x 5mm
- **Cut Out Dimensions (W x H x D):** 52mm x 55mm x 38mm
- **Mounting Hole Spacing:** UK 60mm CTC, EU 60mm CTC
- **Backbox Requirements:** UK single gang backbox / EU single gang backbox
- **Shipping Weight:** 0.3kg
- **Operating Temperature:** 32°F to 104°F (0°C to 40°C)
- **Storage Temperature:** - 4°F to 140°F (- 20°C to 60°C)
- **Power Supply:** Class 1 IEEE 802.3af POE PD or 12V/1A DC, 2-Pin Phoenix connector

Included Accessories

Faceplate	1 x Magnetic Faceplate
------------------	------------------------

Connectivity

- **Audio Input Connectors:** 1 x Analogue Left / Right audio (3.5mm stereo jack)
- **Audio Output Connectors:** 2 x Analogue RCA (Left / Right)
- **Network Connectors:** 1 x PoE Dante® Ethernet Connection (RJ45)
- **Bluetooth:** Bluetooth V5.0 - SBC / MP3 / AAC / APT-X / APTX-LT / APTX-HD, 44.1K-48KHz 16 / 24-bit
- **Configuration Switches:** 1 x Push button (connect / selection)
- **Firmware Upgrade:** 1 x Micro-USB UART port

Acknowledgements

Dante® is a registered trademark of Audinate Pty Ltd.

Regulatory Compliance



Blustream cannot be held responsible for errors in typography or photography. Specifications are subject to change without notice.